

# CD288L Series

HighVoltage



- 160 to 450V, 130°C 5,000hours
- Non solvent proof

## Specifications

Items	Condition	Specifications					
Rated voltage (V)	—	160	200	250	400	450	
Surge voltage (V)	Room temperature	200	250	300	450	500	
Category temperature range (°C)	—	-40 to +105					
Capacitance tolerance (%)	120Hz/20°C	M : ±20					
Dissipation Factor(tan δ)	tanδ(max) 120Hz/20°C	0.15			0.16		
Leakage current(LC)	μA/after 2minutes (max)	CV ≤ 5.6 : 0.03CV + 15μA CV > 5.6 : 0.02CV + 25μA					
Impedance ratio at low temperature	Based on the value at 120Hz, +20°C	-25°C Z/Z <sub>20°C</sub>	6	6	6	6	6
		-40°C Z/Z <sub>20°C</sub>	10	10	10	18	15
Endurance	105°C 5,000hours rated voltage applied (With the rated ripple current)	△C/C	Within ±30% of the initial value				
		tanδ	Less than 300% of the specified value				
		LC	Less than the specified value				

## Marking, Dimensions

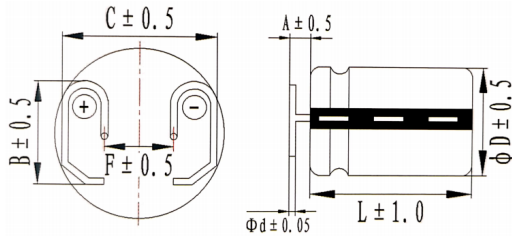

(Unit : mm)

Size code	D <sup>±0.5</sup>	L <sup>±0.5</sup>	A <sup>±0.5</sup>	B <sup>±0.5</sup>	C <sup>±0.5</sup>	φd	F
6.3×10	6.3	10.0	1.8	5.0	6.1	0.5	2.5
8×10.5	8	10.5	1.8	5.5	7.1	0.6	3.5
8×12.5	8	12.5	1.8	5.5	7.1	0.6	3.5
10×13.5	10	13.5	1.8	6.0	8.6	0.6	5.0
10×17.5	10	17.5	1.8	6.0	8.6	0.6	5.0

## Ripple Current Frequency Coefficient

Frequency:F(Hz)	50Hz	120Hz	1kHz	10kHz	100kHz
Capacitance:C(μF) All ITEM	0.50	0.50	0.80	0.90	1.00

## Size, Rated Ripple Current

μF \ V	160	200	250	400	450
1					
1.5					
1.8					
2.2				8×10.5 55	8×10.5 55
3.3				8×12.5 70	8×12.5 70
4.7				10×13.5 95	10×13.5 95
5.6					
6.8				10×13.5 120	
8.2					
10	8×12.5 110	8×12.5 150	10×13.5 185	10×17.5 168	10×17.5 168
15	10×13.5 165	10×13.5 215	10×13.5 220		
22	10×13.5 245	10×17.5 260	10×17.5 270		
27					
33	10×17.5 305				
47					
68					
100					

Case size: φDXL(mm)

Rated ripple current  
mArms(120Hz, 105°C)